

---

**Report To:** Environment & Regeneration Committee    **Date:** 30 August 2018

**Report By:** Corporate Director, Environment, Regeneration & Resources    **Report No:** Lp/079/18

**Contact Officer:** Caroline Ross    **Contact No:** 01475 712115

**Subject:** Proposed Traffic Regulation Order – Disabled Persons’ Parking Places (On Street) Order No. 3 2018

---

## 1.0 PURPOSE

- 1.1 Local Authorities are empowered to make Orders under the Road Traffic Regulation Act 1984 as amended and under the Council’s Scheme of Administration the Head of Environmental and Public Protection is responsible for the making, implementation and review of Traffic Management Orders and Traffic Regulation Orders.
- 1.2 The provision of on-street parking places for use by disabled drivers, who are the holders of a Disabled Person’s Badge, is regulated by The Disabled Persons’ Parking Places (Scotland) Act 2009. Inverclyde Council is required to promote a Traffic Regulation Order to regulate the use of such parking places.

## 2.0 SUMMARY

- 2.1 In order to comply with The Disabled Persons’ Parking Places (Scotland) Act 2009, Section 5, it is proposed to introduce a Traffic Regulation Order to accompany the provision of parking places for the disabled. This will restrict parking to drivers displaying a Disabled Person’s Badge only and will enable the Police to enforce such restrictions. The proposed Order will also revoke those parking places no longer required in order to maximise street parking capacity.

## 3.0 RECOMMENDATION

- 3.1 That the Committee recommend to The Inverclyde Council the making of the Traffic Regulation Order – Disabled Persons’ Parking Places (On-Street) Order No. 3 2018 and remit it to the Head of Environmental and Public Protection and the Head of Legal and Property Services to arrange for its implementation.

**Gerard Malone**  
**Legal and Property Services**

## **4.0 BACKGROUND**

- 4.1 Currently no Traffic Regulation Orders exist at the locations shown in the Order which would prohibit the allocation of parking places for Disabled Person's Badge holders.
- 4.2 No objections were received to the proposed Order.
- 4.3 The Committee is asked to note that, if approved, the Order may not be implemented until the making of the Order has been advertised to allow any persons who so wish a period of six weeks to question the validity of the Order in terms of the Road Traffic Regulation Act 1984.

## **5.0 IMPLICATIONS**

### **Finance**

- 5.1 There are no financial implications arising from this report.

### **Legal**

- 5.2 There are no legal implications arising from this report.

### **Human Resources**

- 5.3 There are no HR implications arising from this report.

### **Equalities**

- 5.4 There are no equalities implications arising from this report.

### **Repopulation**

- 5.5 There are no repopulation implications arising from this report.

## **6.0 CONSULTATIONS**

- 6.1 The proposals have been advertised in the Greenock Telegraph and full details of the proposals have been made available for public inspection during normal office hours at the offices of the Head of Environmental and Public Protection, the Head of Legal and Property Services and at Central, Port Glasgow, and Gourock Libraries. A copy of the draft Order is appended hereto for Members' information. Appendix 1

## **7.0 LIST OF BACKGROUND PAPERS**

- 7.1 None

**THE INVERCLYDE COUNCIL**  
**DISABLED PERSONS' PARKING PLACES**  
**(ON-STREET) ORDER NO. 3 2018**  
**TRAFFIC REGULATION ORDER**

**THE INVERCLYDE COUNCIL**  
**DISABLED PERSONS' PARKING PLACES (ON-STREET)**  
**ORDER NO. 3 2018**

The Inverclyde Council in exercise of the powers conferred on them by Section 32(1) of the Road Traffic Regulation Act 1984 ("the Act") and of all other enabling powers and after consultation with the Chief Constable of Police Scotland in accordance with Part III of Schedule 9 to the Act hereby make the following Order.

1. This Order may be cited as "The Inverclyde Council Disabled Persons' Parking Places (On-Street) Order No. 3 2018" and shall come into operation on ???????, 2018.

2. In this Order the following expressions have the meanings hereby assigned to them:-

"Council" means The Inverclyde Council or its successors as Roads Authority;

"disabled person's badge" means:

- (a) a badge issued under Section 21 of the Chronically Sick and Disabled Persons Act 1970 (as amended);
- (b) a badge issued under a provision of the law of Northern Ireland corresponding to that section; or
- (c) a badge issued by any member State other than the United Kingdom for purposes corresponding to the purposes for which badges under that section are issued;

and which has not ceased to be in force;

"disabled person's vehicle" means a vehicle lawfully displaying a disabled person's badge;

"parking attendant" means a person employed in accordance with Section 63A of the Act to carry out the functions therein;

"parking place" means an area of land specified by number and name in Columns 1 and 2 in the Schedule to this Order;

"traffic sign" means a sign prescribed or authorised under Section 64 of the Act; and

"vehicle" unless the context otherwise requires, means a vehicle of any description and includes a machine or implement of any kind drawn or propelled along roads whether or not by mechanical power.

3. The Schedule titled "Disabled Persons' Parking Places (On Street) Order No. 3 2018" forms the Schedule to this Order.
4. Each area of road which is described in the Schedule to this Order and the plans relative to this Order is hereby designated as a parking place.
5. The parking places shall only be used for the leaving of disabled persons' vehicles displaying a valid disabled person's badge.

6. The limits of each parking place shall be indicated on the carriageway as prescribed by The Traffic Signs Regulations and General Directions 2016.
7. Every vehicle left in any parking place shall stand such that no parking place is occupied by more than one vehicle and that every part of the vehicle is within the limits of the parking place provided that, where the length of a vehicle precludes compliance with this paragraph, such vehicle shall be deemed to be within the limits of a parking place if:-  
  
the extreme front portion or, as the case may be, the extreme rear portion of the vehicle is within 300mm of an indication on the carriageway provided under this Order in relation to the parking place; and  
  
the vehicle, or any part thereof, is not within the limits of any adjoining parking place.
8. Any person duly authorised by the Council or a police officer in uniform or a traffic warden or parking attendant may move or cause to be moved in case of any emergency, to any place they think fit, vehicles left in a parking place.
9. Any person duly authorised by the Council may suspend the use of a parking place or any part thereof whenever such suspension is considered reasonably necessary:-  
  
for the purpose of facilitating the movement of traffic or promoting its safety;  
  
for the purpose of any building operation, demolition, or excavation in or adjacent to the parking place or the laying, erection, alteration, removal or repair in or adjacent to the parking place of any sewer or of any main, pipe, apparatus for the supply of gas, water electricity or of any telecommunications apparatus, traffic sign or parking meter;  
  
for the convenience of occupiers of premises adjacent to the parking place on any occasion of the removal of furniture from one office or dwellinghouse to another or the removal of furniture from such premises to a depository or to such premises from a depository;  
  
on any occasion on which it is likely by reason of some special attraction that any street will be thronged or obstructed; or  
  
for the convenience of occupiers of premises adjacent to the parking place at times of weddings or funerals or on other special occasions.
10. A police officer in uniform may suspend for not longer than twenty four hours the use of a parking place or part thereof whenever such suspension is considered reasonably necessary for the purpose of facilitating the movement of traffic or promoting its safety.

11. This Order insofar as it relates to the parking places to be revoked (R) and amended, as specified in the Schedule to this Order, partially revokes and amends The Inverclyde Council Disabled Persons' Parking Places (On-Street) Order Nos. 01/2007, 02/2010, 01/2010, 02/2011, 03/2011, 04/2013, 02/2015, 03/2015, 04/2017 and 01/2018 respectively.

Sealed with the Common Seal of The Inverclyde Council and subscribed for them and on their behalf by ????????????, Proper Officer, on the ???????? day of ???????, Two Thousand and Eighteen.

**THE INVERCLYDE COUNCIL**

**DISABLED PERSONS' PARKING PLACES  
(ON-STREET) ORDER NO. 3 2018**

**Statement of Reasons for Proposing to Make  
the above Order**

It is considered necessary in order to comply with The Disabled Persons' Parking Places (Scotland) Act 2009, Section 5, to make the above Order to provide assistance for disabled persons who hold a badge under the Disabled Persons (Badges for Motor Vehicles) (Scotland) Regulations 2000 as amended and by revoking those parking places no longer required to maximise street parking capacity.

Willie Rennie  
Head of Environmental & Commercial Services  
1 Ingleston Park  
Cartsburn Street  
GREENOCK  
PA15 4UE





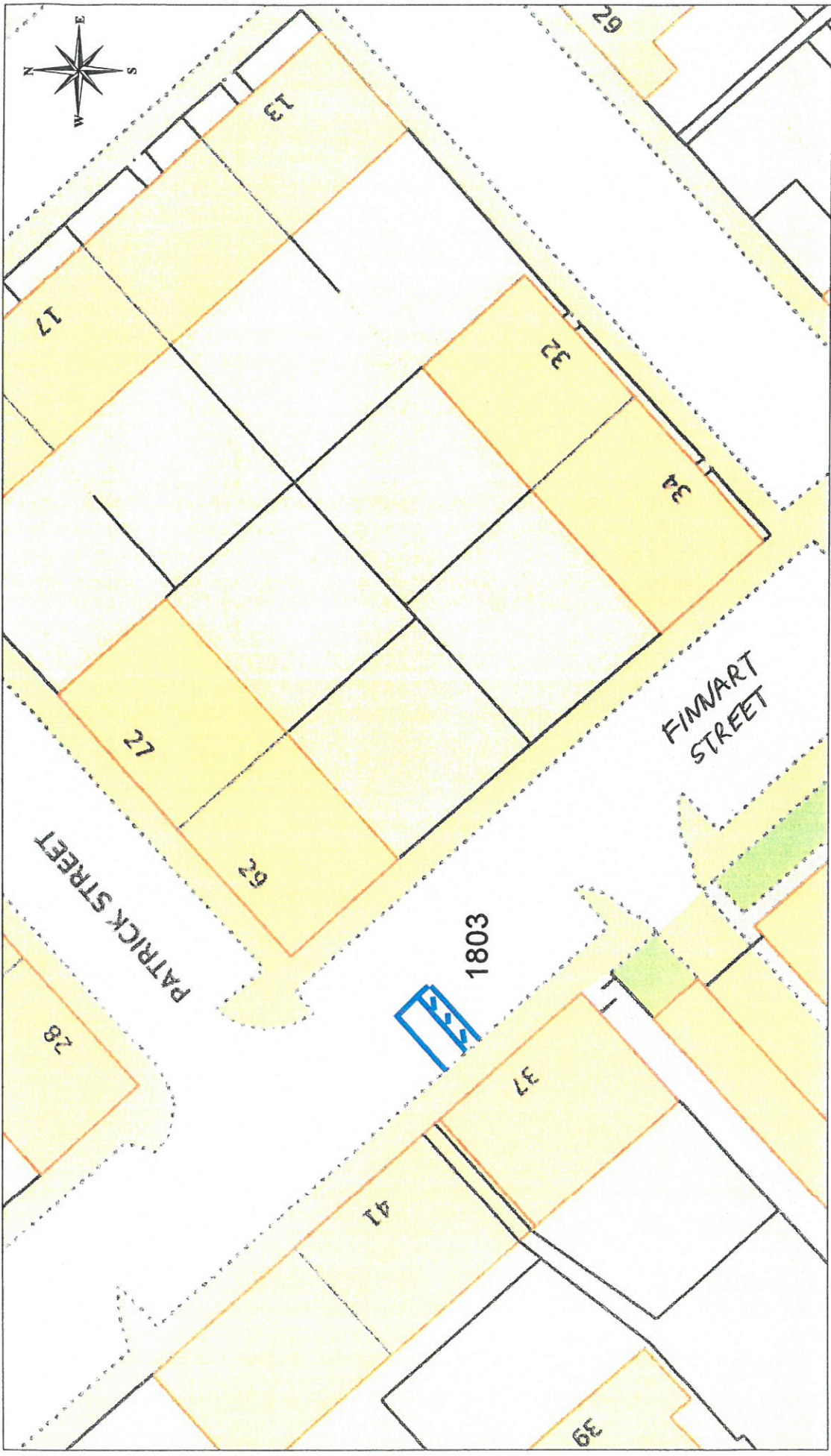



 Ordnance Survey  
 Licensed System Supplier  
This material has been reproduced from Ordnance Survey digital map data with the permission of the Controller of Her Majesty's Stationery Office. © Crown copyright. Licence Number: 100023421

**DISABLED PERSONS' PARKING PLACE**  
**37 FINNART STREET, GREENOCK**  
**PLACE No. 1803**

**Inverclyde**  
**council**  
 Environmental and Commercial Services

Environment, Regeneration & Resources  
 Corporate Director: Scott Allan BSc., C.Eng., M.I.C.E.  
 Municipal Buildings  
 Clyde Square  
 Greenock  
 PA15 1LY  
 Tel: 01475 712712  
 Fax: 01475 712731  
 scott.allan@inverclyde.gov.uk

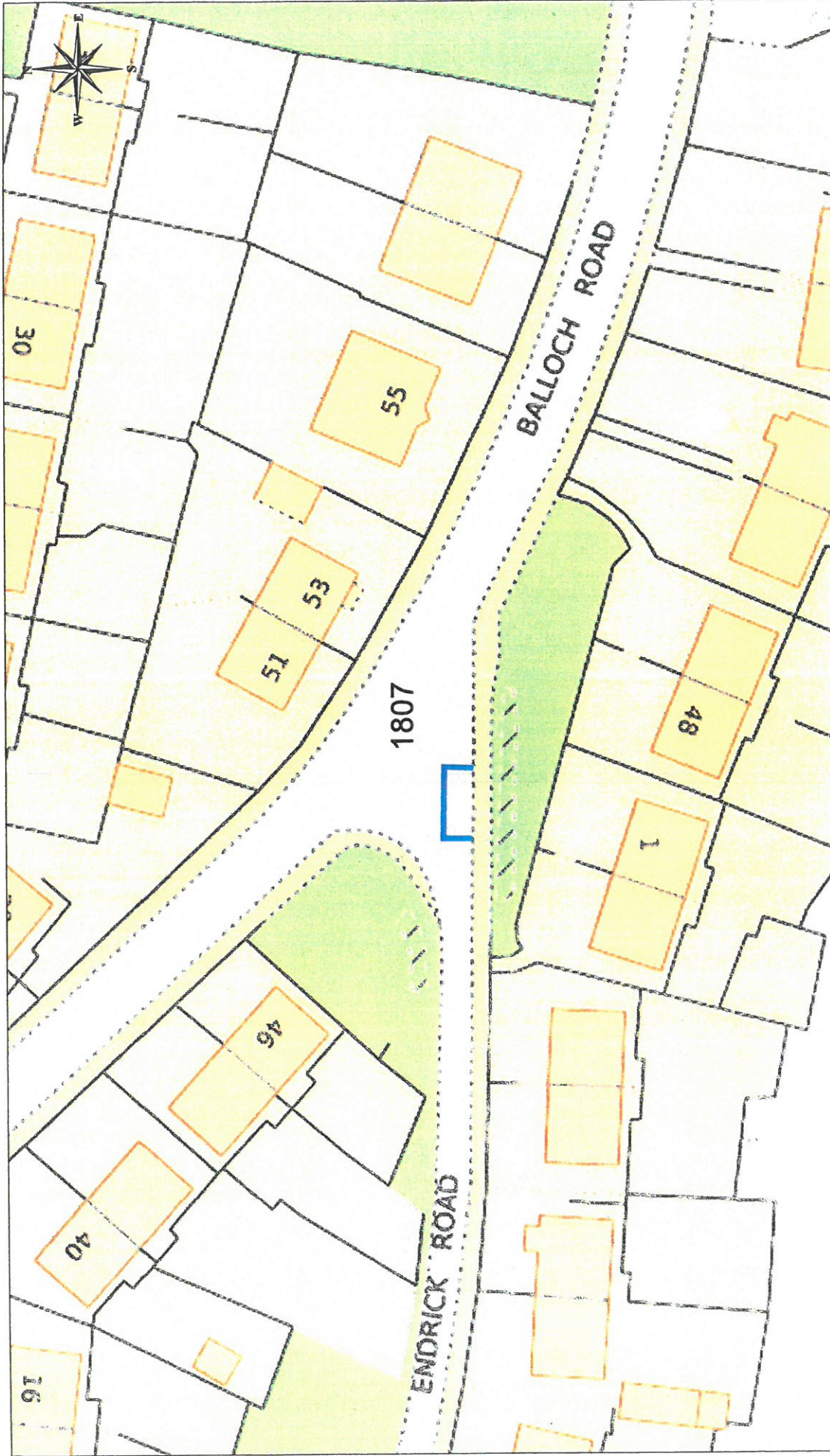





 Ordnance Survey  
 Licensed System Supplier  
This material has been reproduced from Ordnance Survey data with the permission of the Controller of Her Majesty's Stationery Office. Licence Number: 100023421

**DISABLED PERSONS' PARKING PLACE**  
**1 ENDRICK ROAD, GREENOCK**  
**PLACE No. 1807**

**Inverclyde**  
**Council**  
 Environmental and Commercial Services

Environment, Regeneration & Resources  
 Corporate Director: Scott Allan BSc., C.Eng., M.I.C.E.  
 Municipal Buildings  
 Clyde Square  
 Greenock  
 PA15 1LY  
 Tel: 01475 712712  
 Fax: 01475 712731  
 scott.allan@inverclyde.gov.uk

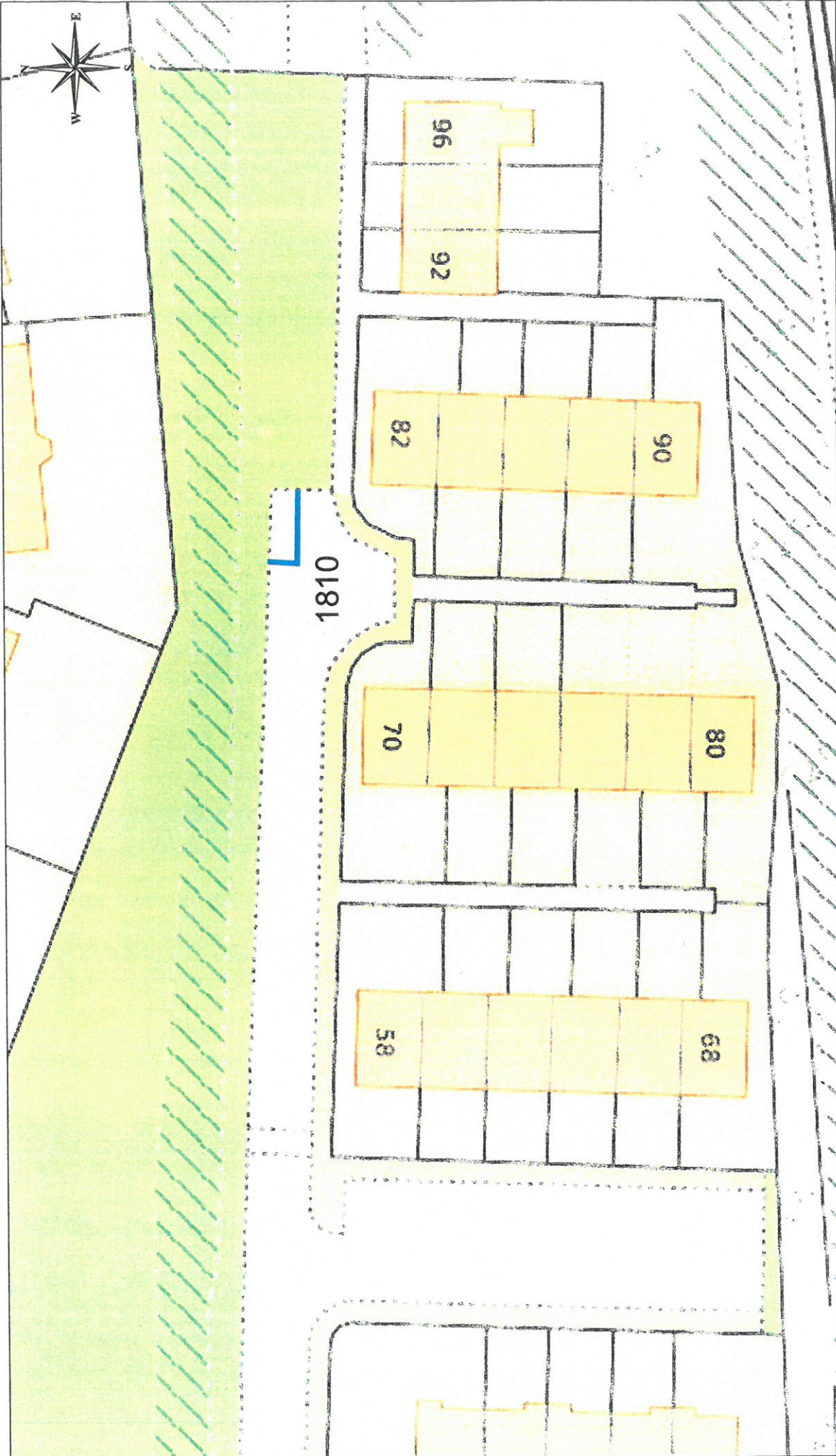



**Inverclyde**  
Council

Environmental and Commercial Services

Environment, Regeneration & Resources  
Corporate Director: Scott Allan BSc., C.Eng., M.I.C.E.

Municipal Buildings  
Clyde Square  
Greenock  
PA15 1LY  
Tel: 01475 712712  
Fax: 01475 712731

DISABLED PERSONS' PARKING PLACE  
96 SINCLAIR STREET, GREENOCK  
PLACE No. 1810



Licensed System Supplier  
This maplet has been reproduced from  
Ordnance Survey digital map data with  
the permission of the Controller of  
Her Majesty's Stationery Office.  
© Crown Copyright



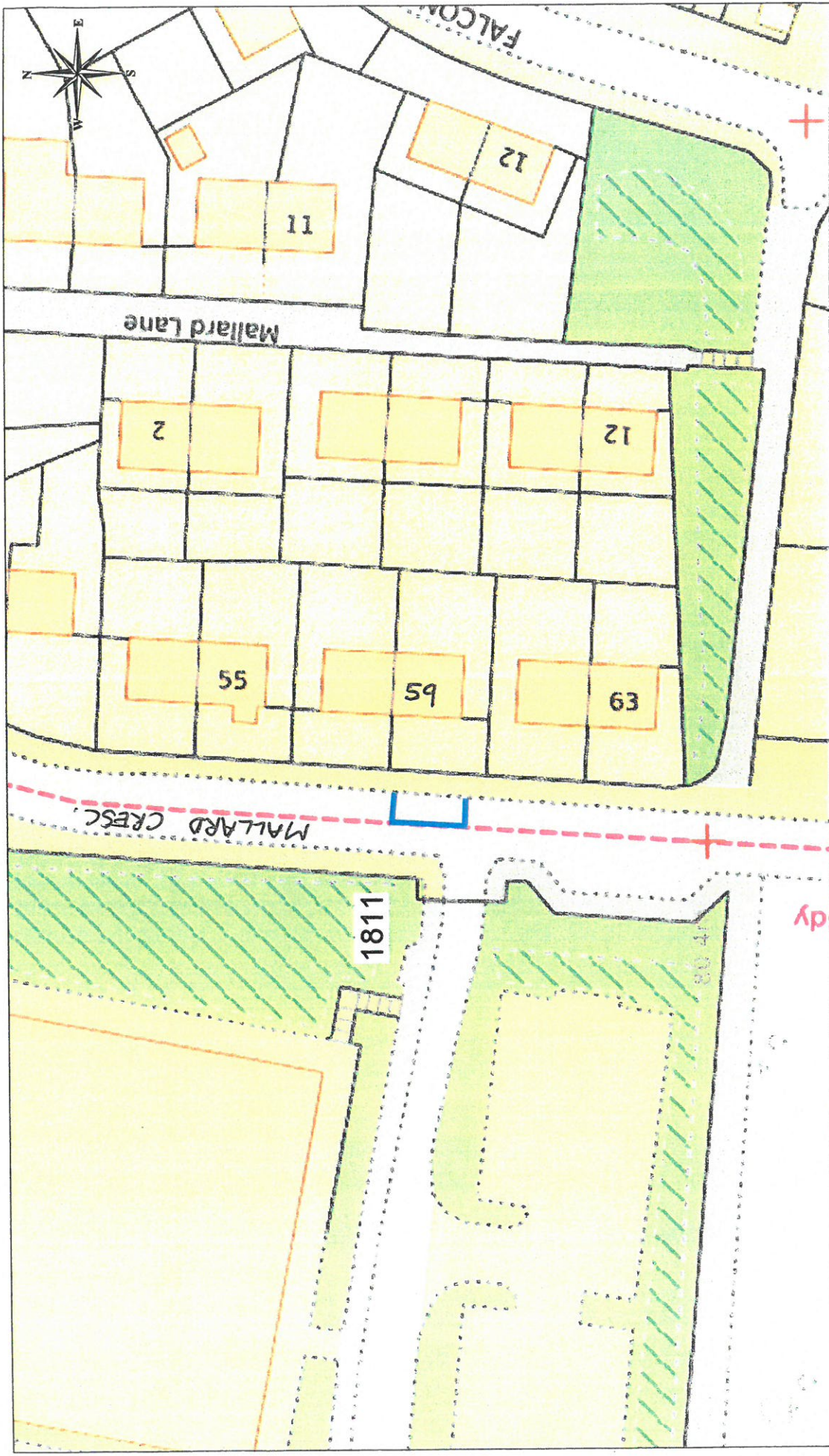



 Licensed System Supplier  
 This material has been reproduced from  
 Ordnance Survey digital maps data, with  
 the permission of the Controller of  
 Her Majesty's Stationery Office.  
 © Crown copyright. 10003421  
 Licence Number: 10003421

DISABLED PERSONS' PARKING PLACE  
 59 MALLARD CRESCENT, GREENOCK  
 PLACE NO. 1811

**Inverclyde**  
 council  
 Environmental and Commercial Services

Environment, Regeneration & Resources  
 Corporate Director: Scott Allan BSc., C.Eng., M.I.C.E.  
 Municipal Buildings  
 Clyde Square  
 Greenock  
 PA15 1LJ  
 Tel: 01475 712712  
 Fax: 01475 712711  
 scott.allan@inverclyde.gov.uk

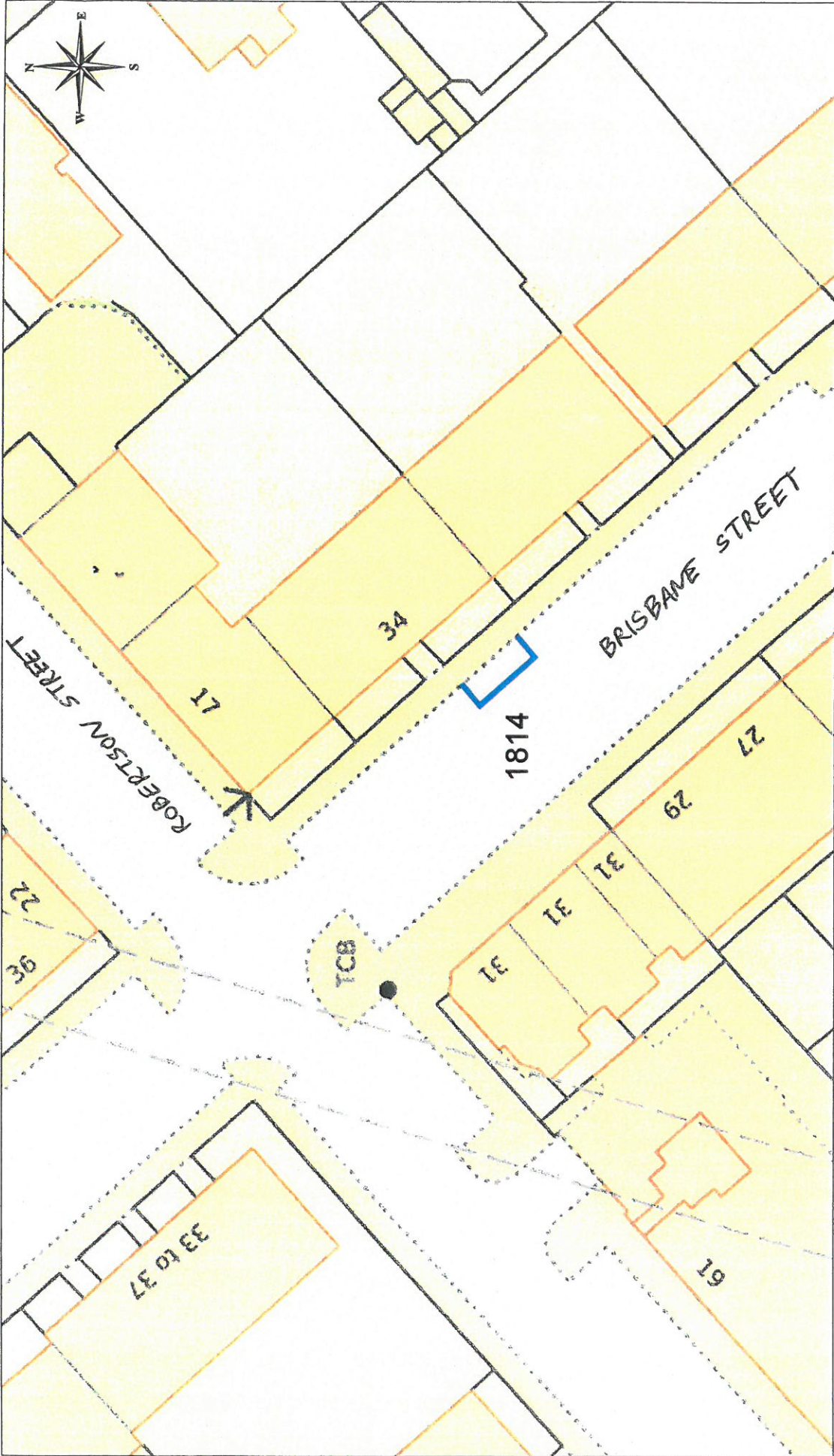



**Inverclyde**  
council  
Environmental and Commercial Services

Environment, Regeneration & Resources  
Corporate Director: Scott Allan BSc., C.Eng., M.I.C.E.  
Municipal Buildings  
Clackmannon  
Greenock  
PA15 1LY  
Tel: 01475 712712  
Fax: 01475 712731  
scott.allan@inverclyde.gov.uk

DISABLED PERSONS' PARKING PLACE  
34 BRISBANE STREET, GREENOCK  
PLACE No. 1814



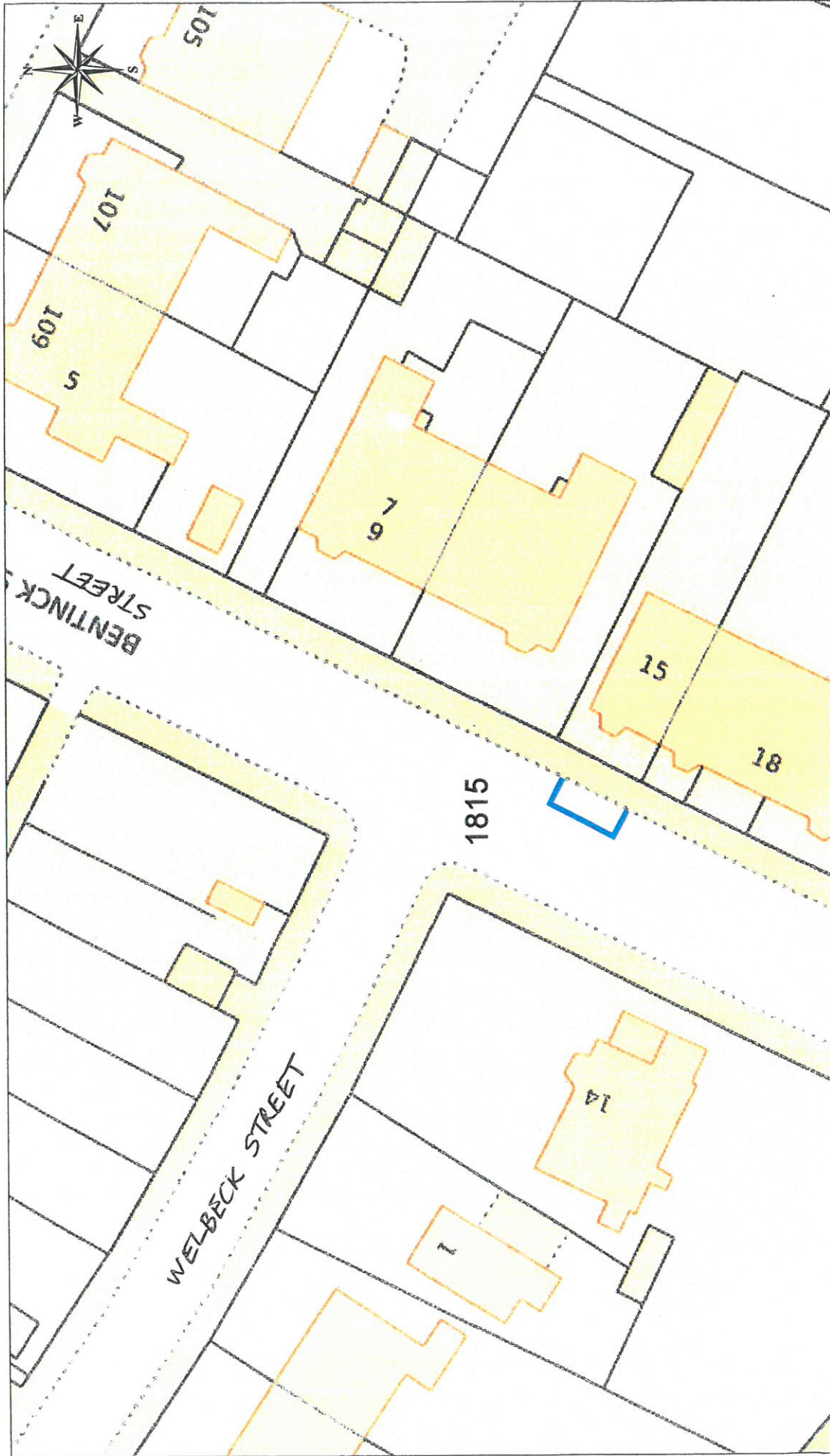

DISABLED PERSONS' PARKING PLACE  
 15 BENTINCK STREET, GREENOCK  
 PLACE No. 1815

**Inverclyde** council  
 Environmental and Commercial Services  
 Environment, Regeneration & Resources  
 Corporate Director: Scott Allan BSc., C.Eng., M.I.C.E.  
 Municipal Buildings  
 Clyde Square  
 Greenock  
 PA15 1LY  
 Tel: 01475 712712  
 Fax: 01475 712731  
 scott.allan@inverclyde.gov.uk



HEAD OF PLANNING AND TRANSPORTATION  
F. K. WILLIAMSON

6 CATHCART SQUARE  
GREENOCK, PA15 1LS

DISABLED PERSONS' PARKING PLACE  
71 BROADSTONE AVENUE, PORT GLASGOW  
PLACE No. 0646 REVOCATION

Scale : 1:500  
Prepared by : R. MACKAY  
Drawn by : R. MACKAY  
Date : FEB 2007  
Checked by :  
Approved by :  
File No. : 19/12

Reproduced from Ordnance Survey mapping with the permission of the Controller of Her Majesty's Stationery Office. Crown Copyright and may result in prosecution or legal proceedings.

**Ordnance Survey**  
Licence No. 1000023421

# Inverclyde council ENVIRONMENTAL SERVICES

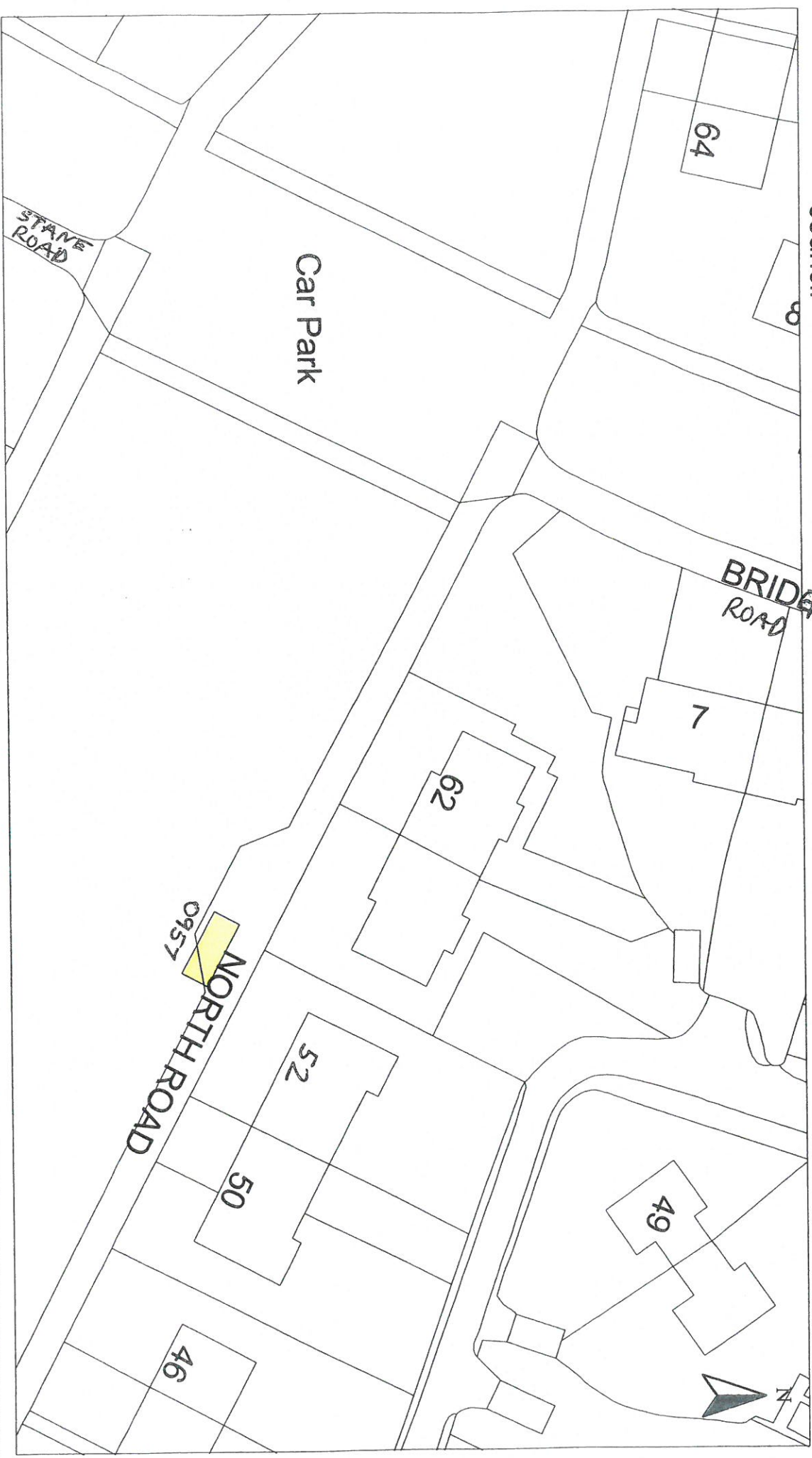

HEAD OF SERVICE  
ALAN G BARNES MCIMM CENV

71 EAST HAMILTON STREET  
GREENOCK, PA15 2UA

Reproduced from Ordnance Survey mapping with the permission of the Ordnance Survey by Crown Copyright. Unauthorised reproduction infringes Crown Copyright and may result in prosecution or legal proceedings.

Ordnance Survey  
Licence No. LA03097L

DISABLED PERSONS' PARKING PLACE  
52 NORTH ROAD, PORT GLASGOW  
PLACE No. 0957 REVOCATION

Scale :	1:500	Date :	MAR 2010
Prepared by :	R. MACKAY	Checked by :	
Drawn by :	R. MACKAY	Approved by :	
Drawing No. :		File No. :	19/12





HEAD OF SERVICE  
ALAN G BARNES MCIMM CENV

71 EAST HAMILTON STREET  
GREENOCK, PA15 2UA

Disabled Bays

Reproduced from Ordnance Survey mapping with the permission of the Controller of Her Majesty's Stationery Office. Crown Copyright. Unauthorised reproduction infringes Crown Copyright and may result in prosecution or legal proceedings.

Licence No. LA03097L

DISABLED PERSONS' PARKING PLACE  
64 FANCY FARM ROAD, GREENOCK  
PLACE No. 0966 REVOCATION

Scale :	1:500	Date :	NOV 2009
Prepared by :	R. MACKAY	Checked by :	
Drawn by :	R. MACKAY	Approved by :	
Drawing No. :		File No. :	19/12

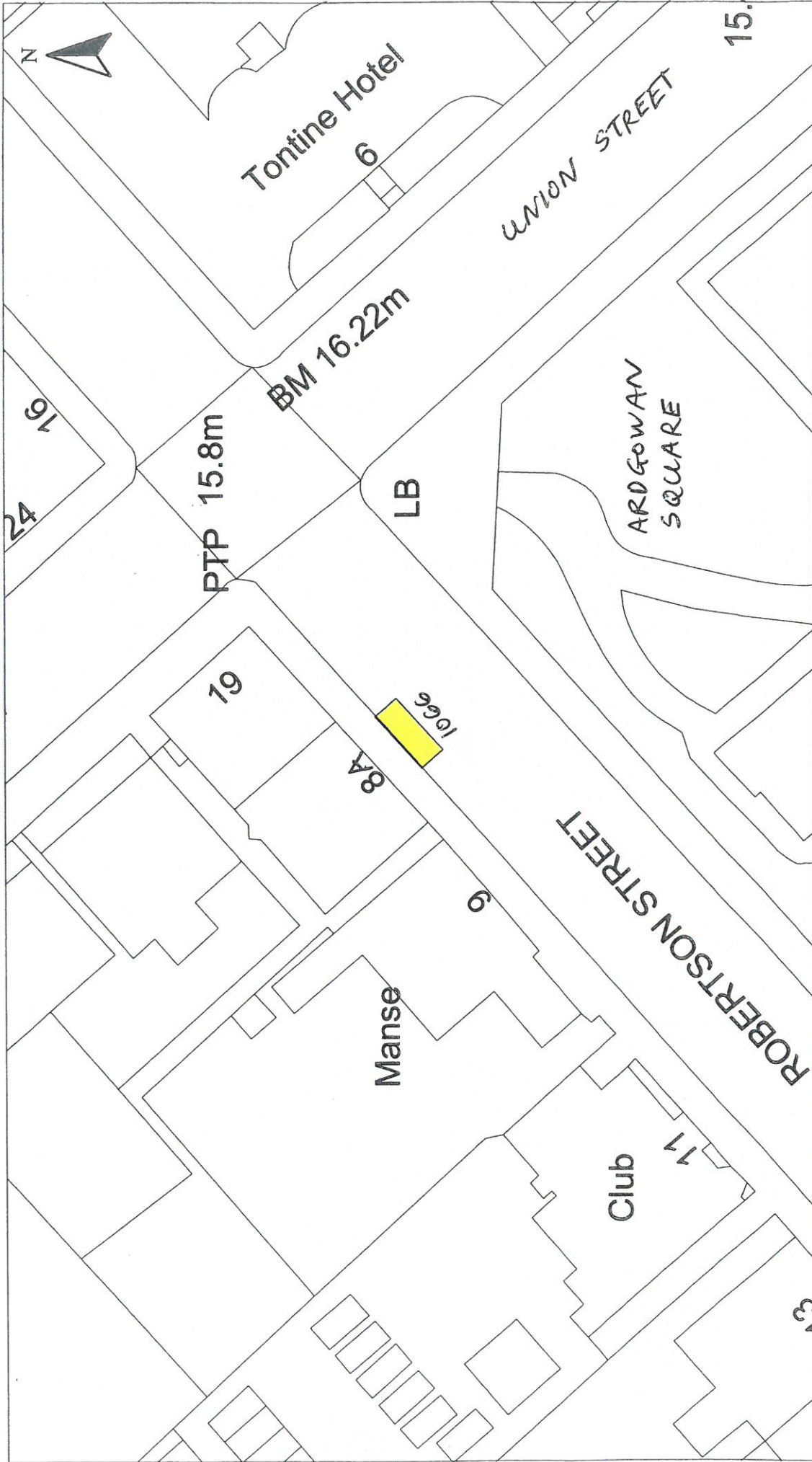

HEAD OF SERVICE  
IAN MOFFAT

71 EAST HAMILTON STREET  
GREENOCK, PA15 2UA

Disabled Bays

Reproduced from Ordnance Survey mapping with the permission of the Controller of Her Majesty's Stationery Office. Crown Copyright. Unauthorised reproduction infringes Crown Copyright and may result in prosecution or legal proceedings.



Licence No. LA03097L

**DISABLED PERSONS' PARKING PLACE**  
**8A ARDGOWAN SQUARE, GREENOCK**  
**PLACE No. 1066 REVOCATION**

Scale : 1:500

Prepared by : R. MACKAY

Drawn by : R. MACKAY

Drawing No. :

Date : JAN 2011

Checked by :

Approved by :

File No. : 19/12



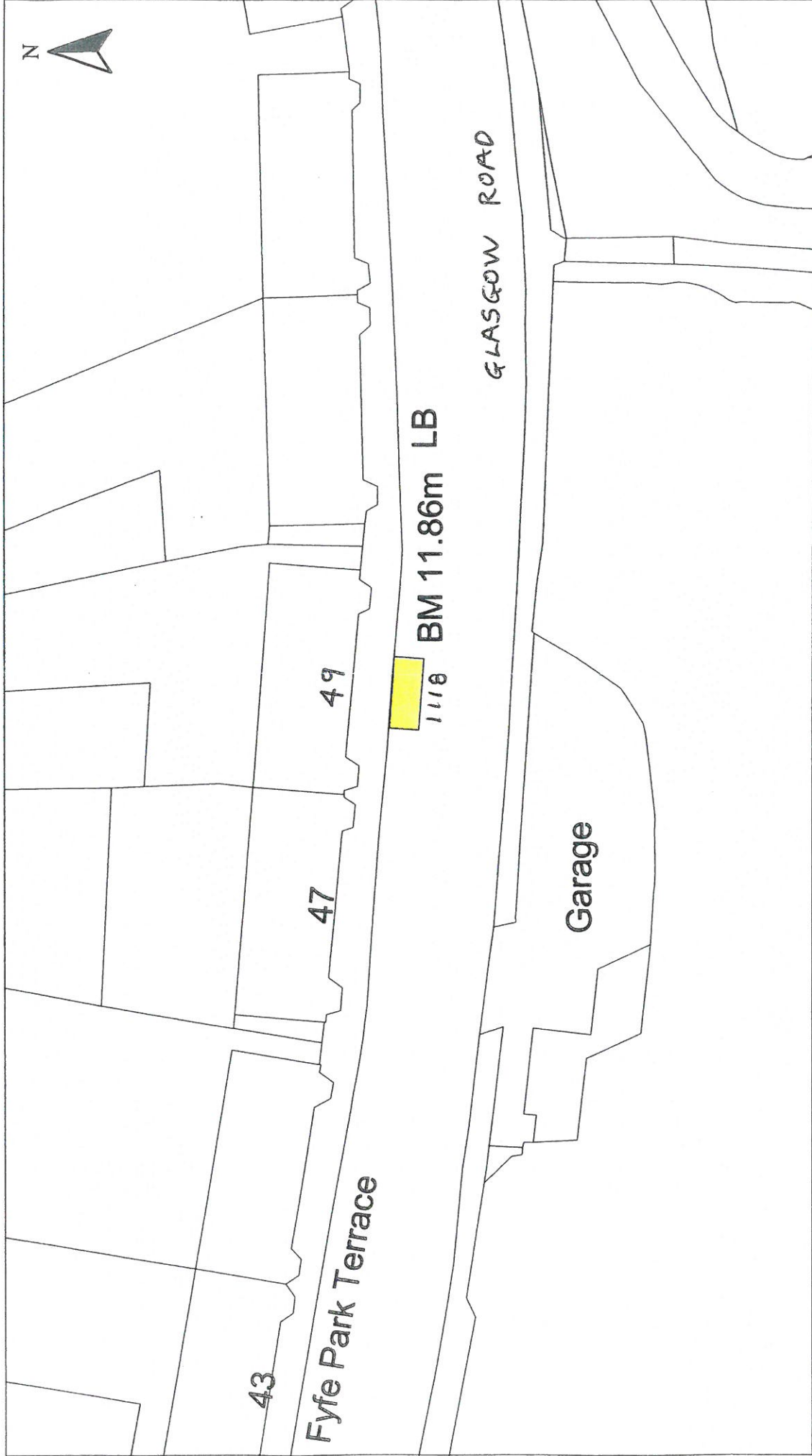

HEAD OF SERVICE IAN MOFFAT  71 EAST HAMILTON STREET GREENOCK, PA15 2JA	Scale : 1:500		Date : APR 2011
	Prepared by : R. MACKAY		Checked by :
Disabled Bays	Drawn by : R. MACKAY		Approved by :
	Licence No. LA03097L		File No. : 19/12
Reproduced from Ordnance Survey mapping with the permission of the Controller of Her Majesty's Stationery Office. Crown Copyright. Unauthorised reproduction infringes Crown Copyright and may result in prosecution or legal proceedings.			
Ordnance Survey			
DISABLED PERSONS' PARKING PLACE 49 GLASGOW ROAD, PORT GLASGOW PLACE No. 1118 REVOCATION			

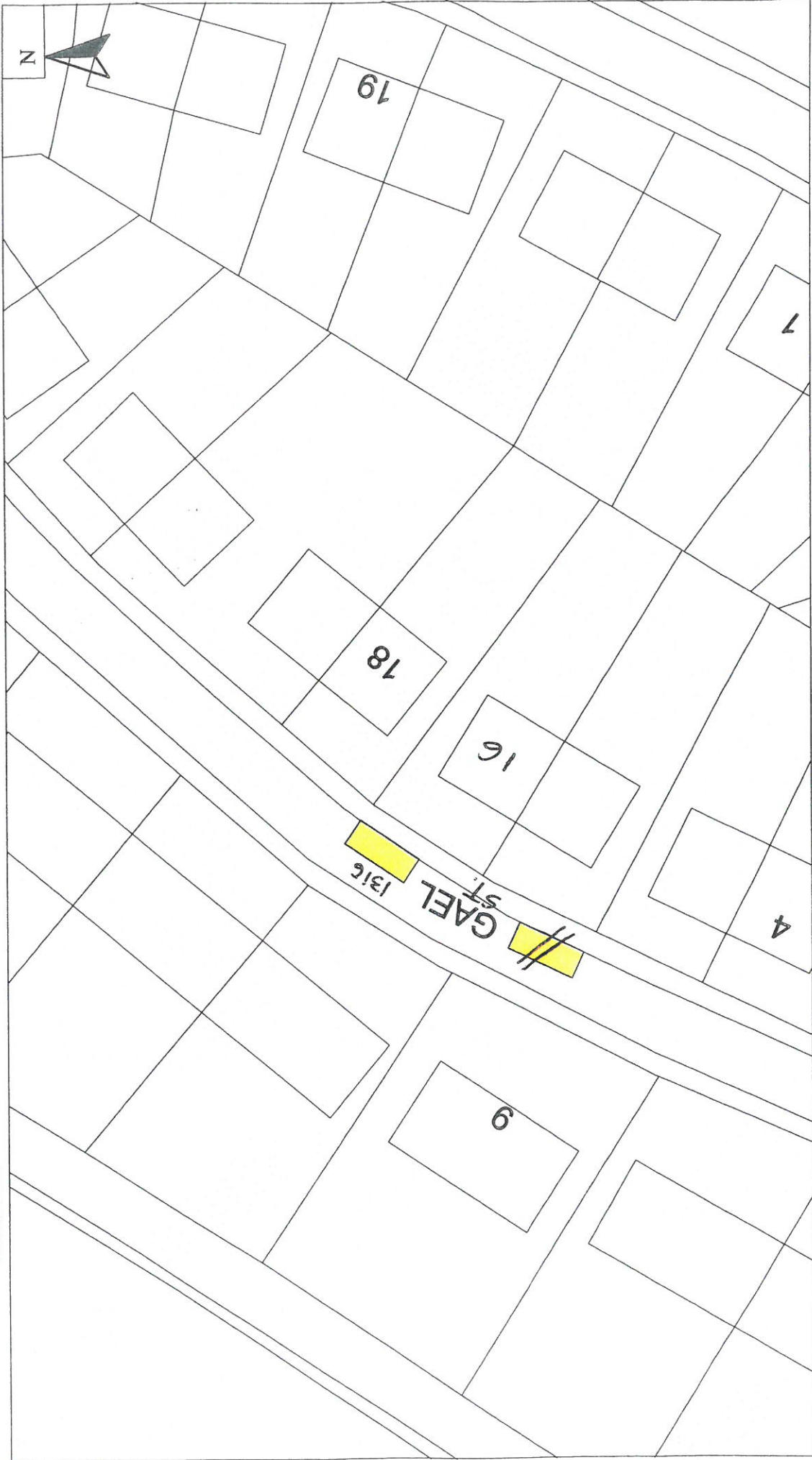

HEAD OF SERVICE  
IAN MOFFAT

71 EAST HAMILTON STREET  
GREENOCK, PA15 2UA

Disabled Bays

Reproduced from Ordnance Survey mapping with the permission of the Controller of Her Majesty's Stationary Office. Crown Copyright. Unauthorised reproduction infringes Crown Copyright and may result in prosecution or legal proceedings.



Licence No. LA03097L

**DISABLED PERSONS' PARKING PLACE**  
16 GAEL STREET, GREENOCK  
PLACE No. 1316 REVOCATION

Scale : 1:500

Prepared by : R. MACKAY

Drawn by : R. MACKAY

Drawing No. :

Date : JULY 2013

Checked by :

Approved by :

File No. : 19/12



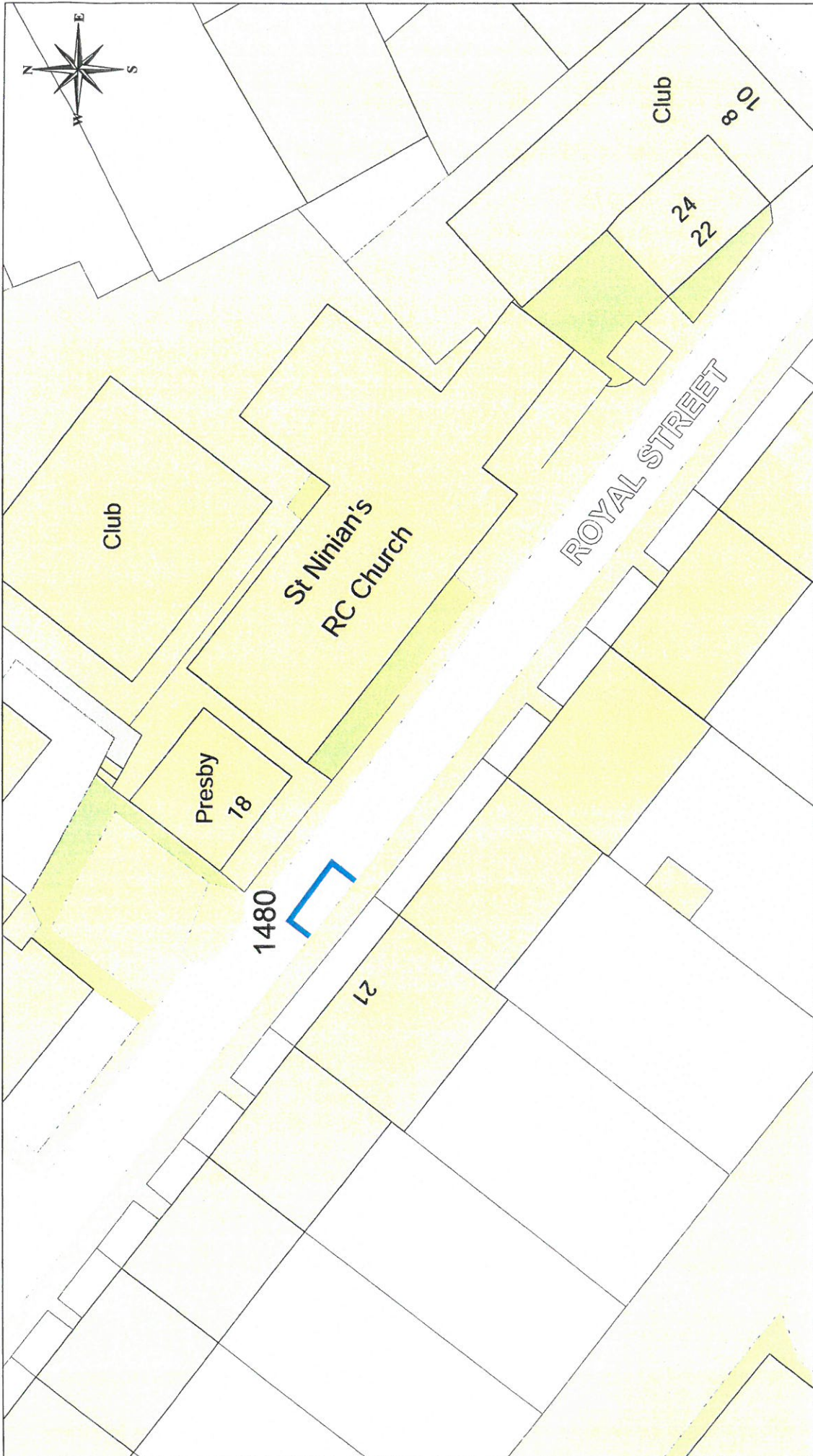

DISABLED PERSONS' PARKING PLACE  
21 ROYAL STREET, GOUROCK  
PLACE No. 1480 REVOCATION





**DISABLED PERSONS' PARKING PLACE**  
**53 SHANKLAND ROAD, GREENOCK**  
**PLACE No. 1514 REVOCATION**



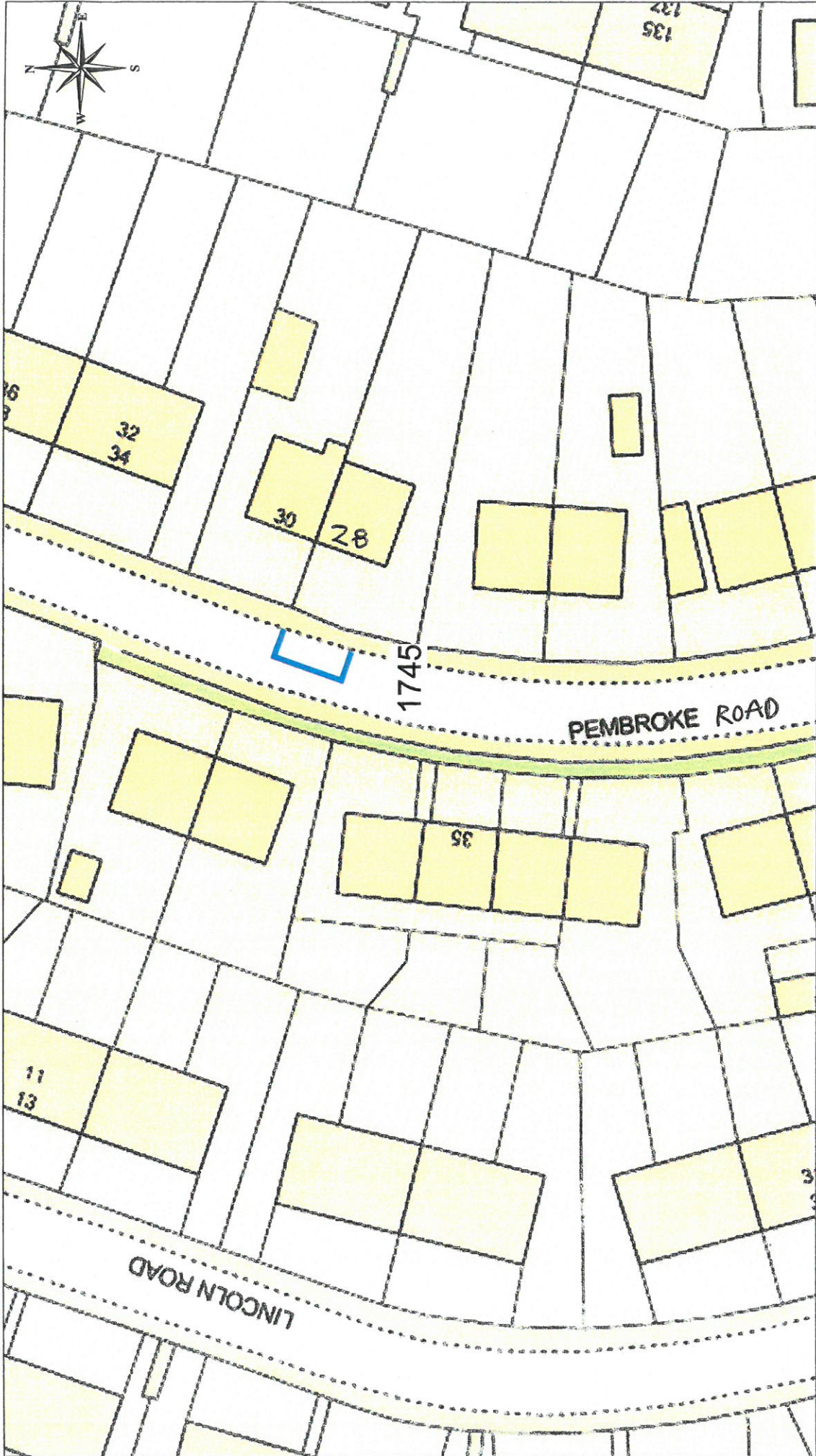

**DISABLED PERSONS' PARKING PLACE**  
**28 PEMBROKE ROAD, GREENOCK**  
**PLACE No. 1745 REVOCATION**



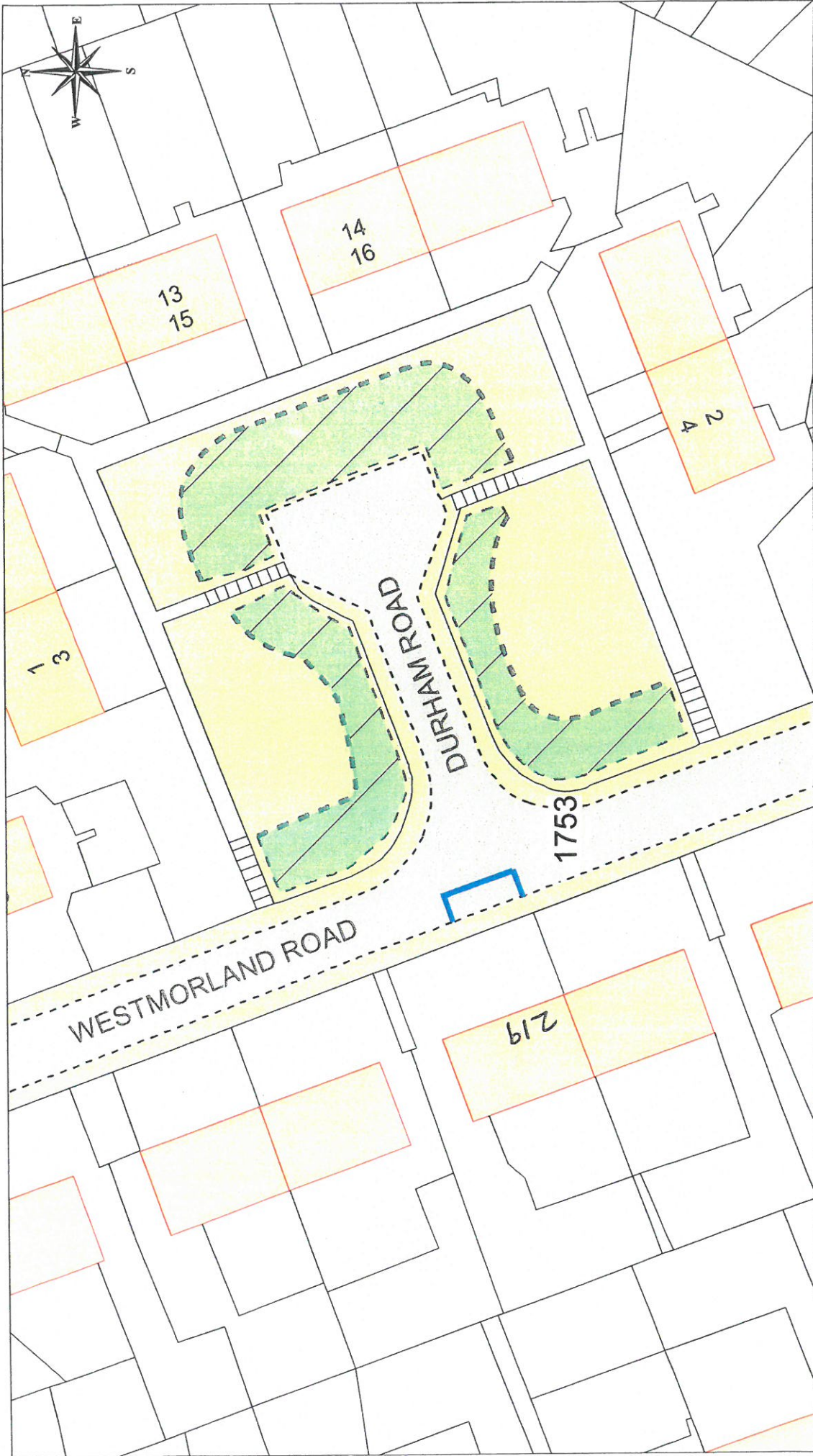

**DISABLED PERSONS' PARKING PLACE**  
**219 WESTMORLAND ROAD, GREENOCK**  
**PLACE No. 1753 REVOCATION**